

# Top 12 Reasons to Switch from Mastercam to Fusion 360

## Fully Integrated CAD, CAM, and So Much More.

Fusion 360 connects the entire product development process to the cloud, fusing together tools like CAD, CAM, simulation, data management, industrial design, documentation, rendering, and generative design into a single tool.

Fusion 360 connects to the cloud for simple collaboration with teams that sit in the same office or thousands of miles away. Fully integrated CAD combined with AnyCAD technology means you stay connected to the design data, even when it comes from a third party. Streamline your manufacturing process to start making better parts, today. Learn more at [autode.sk/fusion360](http://autode.sk/fusion360)

Manufacturing is changing. So should your tools.

## 1. Integrated Data Management, CAD, and Documentation

Fusion 360 not only has a full suite of manufacturing tools, but fully integrated design, modeling, and simulation tools. Parametric modeling capabilities give you **intuitive and powerful tools for fixture design** that update seamlessly when designs change. The modeling capabilities also include **direct editing to simplify quick model edits**, especially on imported parts, **surface modeling tools for advanced toolpath control**, and **drawings for documentation** – all in one common interface. All of this functionality comes in a user-friendly structure to make it easy to save, access, and manage your design data whether you're a new or advanced CAD user.

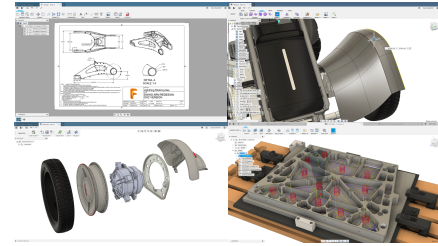

## 2. Unlock New Collaboration Workflows

When you program machines, you don't just have to deal with the difficulties of managing CAD data – you also have to make sure your toolpaths are up to date and that the correct program is loaded on to the machine. Fusion 360 solves issues of legacy data management with **version control**, so you can roll back previous versions if needed – CAM data included. When it's time to share a design, Fusion 360 allows you to quickly create **Share Links** that you can password protect, so it's easy to share data while keeping it safe. Finally, your data is accessible on a **Mac, PC, and mobile device** so you can get to work anywhere, anytime.

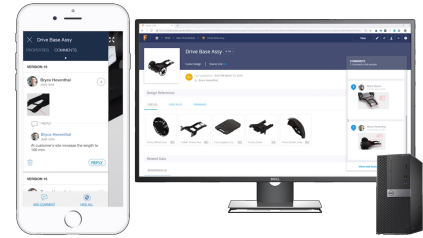

## 3. Associative Data Links with AnyCAD

Fusion 360 already makes data management easier with tools like version control, share links, and multi-platform access. But Fusion 360 also makes it easy to collaborate with your customers or partners who use other tools. **AnyCAD** maintains an associative link between non-native data like STEP or IGES and even files from other CAD packages like Inventor, Creo, SolidWorks, NX, and more. That link helps streamline your collaboration process across platforms.



## 4. Free Self-paced Training Content

Our vision is to make professional design and manufacturing tools accessible to people across the industry in companies of any size with any capabilities. One important piece of that vision is accessible training. So, we built content from **full courses**, purpose-built to help professionals get up and running in Fusion 360, to **Quick Tips** that share short best practices, so you have access to the training you need to be successful.

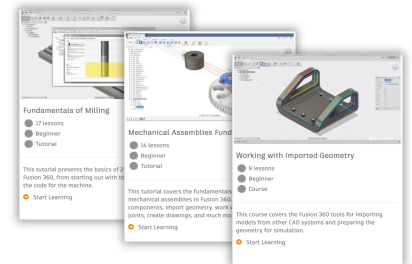

## 5. Extensive Library of Free Post Processors

Of course, if you can't take the toolpaths from the CAM software out to the machine, you might as well have not programmed it at all. We think that everyone should have access to the post processor they need, so we offer an **extensive online library of free, open source, post processors**. But we also know that not everyone has the time to customize their own post, so we have a **Post Services Marketplace** where you can connect with partners for paid post processor customizations.

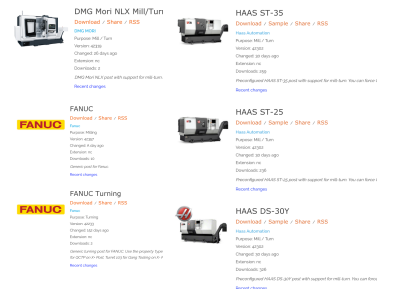

## 6. Simplified Setup Sheet Creation

Create customizable **Setup Sheets** in a matter of seconds to bridge the communication gap between the programming office and the operators on the shop floor. Include information like setup images, tool lists, maximum spindle speeds and feed rates, and more to prevent human errors at the machine. Print the setup sheets or open the **HTML format in any browser** for flexible access – whether you want to clip the sheet to the machine or view it from a tablet.

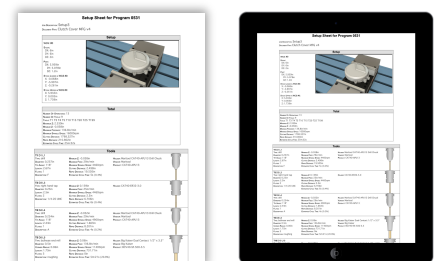

## 7. Ease of Use – Consistent and Intelligent Programming

From simple drilling to turning operations to the most complex multi-axis milling strategies, Fusion 360 has a consistent approach to programming that makes it easy to learn and easy to pick up where you left off. Each operation is divided into a **5 Tab System**: Tool, Geometry, Heights, Passes, and Linking. Sorting each operation into these tabs makes it easy to locate and set the parameters you need to match your programming intent. No need to memorize giant dialogs and struggle to find that one parameter you're looking for. And in case you don't remember what a parameter means, **Tool Tips** appear over nearly every input, so you can quickly get back on track.

Fusion also makes programming easy with intelligence built in at various points of the programming process. **Open pockets are automatically detected** when chaining, with a two click process to switch between open and closed if needed. **Tool Orientation can be defined directly from model geometry**, with the option to create and use construction geometry only if needed, allowing you to create 5-axis toolpaths in just 2 clicks. And because there's no dongle needed, everyone can model, program, and post at the same time without the hassle of passing off computer access, network licenses, or dongles. Fusion 360 simply gives your whole team the tools they need any time, anywhere.

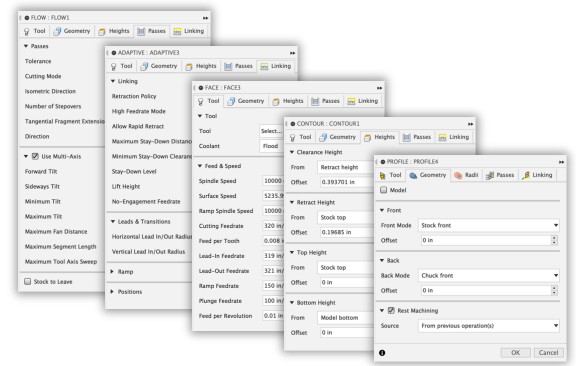

## 8. Low Cost of Entry

We believe that professional design and manufacturing software should be available to everyone, so we made Fusion 360 accessible to team of all sizes with an **affordable price point of \$495/year**. This means for less than your Mastercam maintenance, you can subscribe to Fusion 360 and access not only a full suite of CAM tools, but fully integrated design, simulation, documentation, and more. For less than a single Mastercam seat, you can put Fusion in the **hands of every person on the shop floor**.

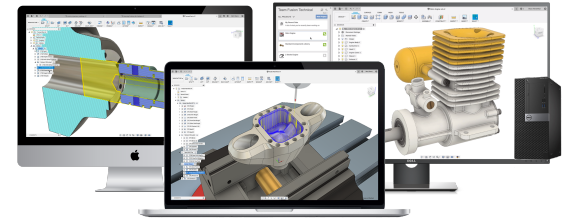

## 9. Account-Based Access and Settings

Fusion 360 allows you to **access your data anytime, anywhere, on any computer**. Because all of your data and settings are tied to your account, you can log in on any computer and instantly access all of your designs, projects, toolpaths, and even cloud libraries of **tools, templates, and post processors**. There's no need for a dongle, no need to claim the network license, and no arguing over whose turn it is to use the CAM system. Your user interface settings are also tied to your account, so no time is lost readjusting and reconfiguring the entire user interface to what you're used to – it happens automatically when you log in.



## 10. Seamless Product Updates

Fusion 360 updates every 6 weeks with seamless **updates that install in just minutes**. Updates integrate new features and workflows into the interface without significant changes, preventing significant disruptions to your process. Basically, Fusion just gets incrementally better over time with no need for you to essentially relearn the software every time. The updates are pushed live to your computer in about the same amount of data as an email, and there's no need to enter a product key or insert a dongle to access the latest and greatest functionality.



## 11. Active and Passionate Community

There is an **active user community** full of passionate users of all levels to help answer questions and discuss best practices. Forums are also **frequented by Autodesk staff** including product managers and developers, so we help answer your questions while staying in touch with your feature requests and bug reports. There are dedicated forums for [Manufacturing](#), [Post Processors](#), and [Design](#) so you know where to post to get the expertise you need. In addition to the user forums, the [Fusion IdeaStation](#) is a place you can make feature requests or improvements. To date, we have **implemented 560 user ideas** into Fusion 360! Join this active and passionate community of users and help us build the best Fusion 360.

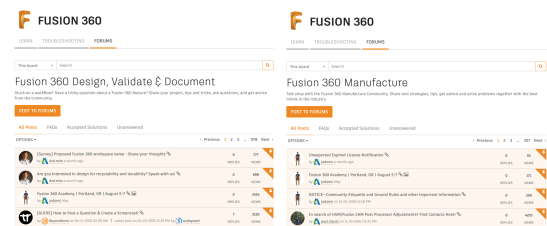

## 12. Quickly Transition Your Legacy Data

We know that one of the biggest hurdles to switching to a new tool is reworking all of your legacy data – and with manufacturing, it's more than just design data. We built a **tool library translator** for this express purpose. Load in your old Mastercam libraries and create full Fusion 360 tool libraries in a matter of seconds. No long, manual, painstaking process of sitting down and manually entering each tool. All so you can get up and running as fast as possible.

